



45 Oswell Road, Severn Meadows, Shrewsbury, SY2 5YL

3 bedroom mews house — £325,000 Freehold

£325,000 Freehold — 3 bedroom mews house

sales@cgpooks.co.uk

Well situated in a quiet and private cul de sac, this modern mews style property offers improved and versatile accommodation over 3 floors, along with a driveway, garage and very attractively landscaped garden.

KEY FEATURES

- Covered entrance area to hall with decoratively tiled flooring, built in storage and cloakroom.
- Ground floor family room with feature panelled walls, wood effect flooring and large built in storage cupboard to one wall. There is also a window and glazed double doors opening onto the covered decked terrace. This room would also suit being a 4th bedroom or home office.
- From the hall there is a staircase to the large open plan first floor living area with window and Juliet balcony overlooking the garden.
- Separate kitchen/dining room with wood effect flooring, window and further Juliet balcony to front.
- The kitchen area has a range of fitted units and some integrated appliances.
- On the second floor there are 3 bedrooms and a family bathroom. The main bedroom also has an ensuite shower room.
- uPVC double glazed windows and gas fired central heating.
- Driveway providing parking and access to the integral garage which has an internal door to hall.
- Very attractively landscaped southerly facing mature rear garden benefiting from a lovely, decked terrace with glazed veranda.
- A quiet and convenient location, within easy access of the town centre.

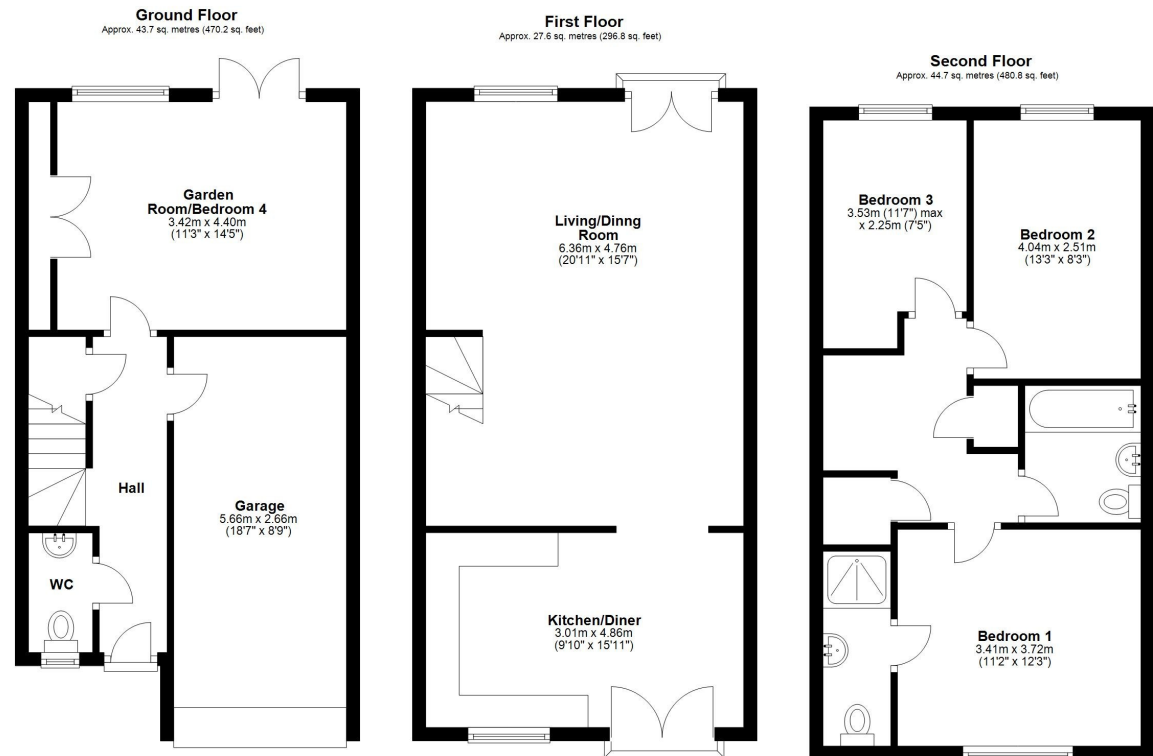

Total area: approx. 115.9 sq. metres (1247.8 sq. feet)







45 Oswell Road, Severn Meadows, Shrewsbury, SY2 5YL

£325,000 Freehold — 3 bedroom mews house

sales@cgpooks.co.uk

rightmove

onTheMarket.com

RICS
Regulated by RICS

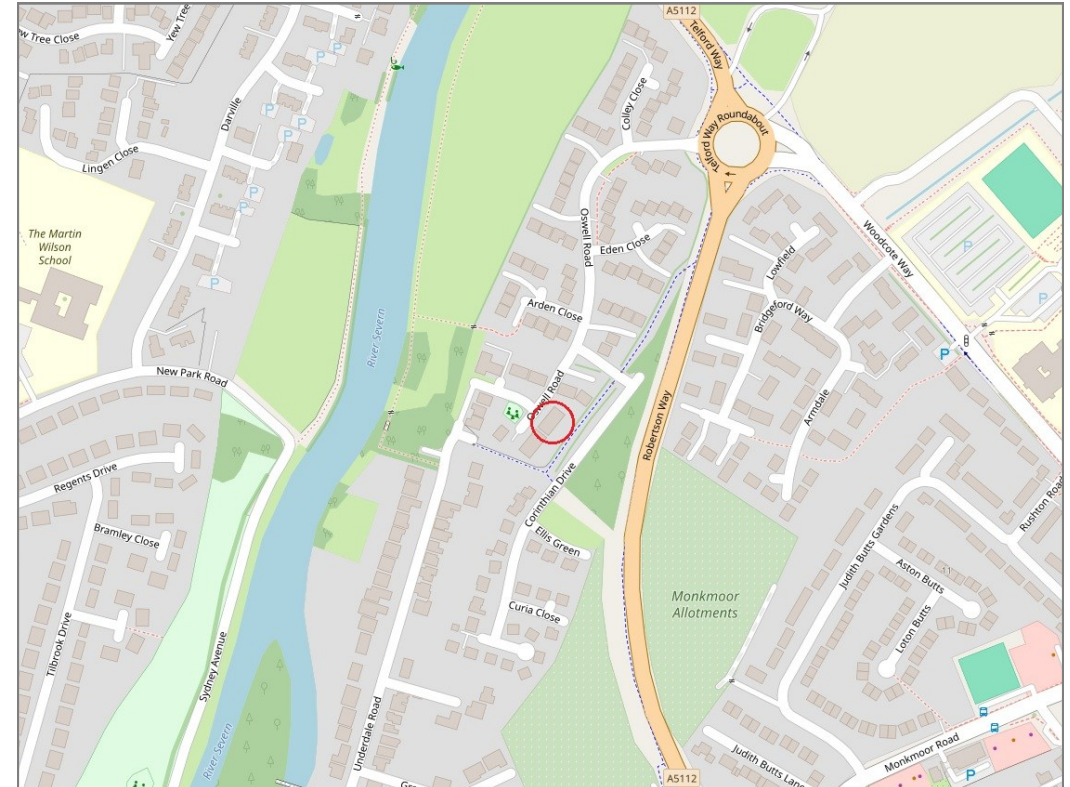

BOUNDARIES NOT CONFIRMED

Tenure	Freehold
Local Authority	Shropshire Council
Council Tax	Band D
EPC Band	Band C
Services	All mains services are connected

Expert mortgage advice available

3 Barker St, Shrewsbury SY1 1QF

Cooper Green Pooks
01743 276666



Your home may be repossessed if you do not keep up repayments on your mortgage.

There may be a fee for mortgage advice. The actual amount you pay will depend upon your circumstances. The fee is up to 1% but a typical fee is 0.3% of the amount borrowed.

45 Oswell Road, Severn Meadows, Shrewsbury, SY2 5YL

Coopergreenpooks.co.uk

£325,000 Freehold — 3 bedroom mews house

sales@cgpooks.co.uk

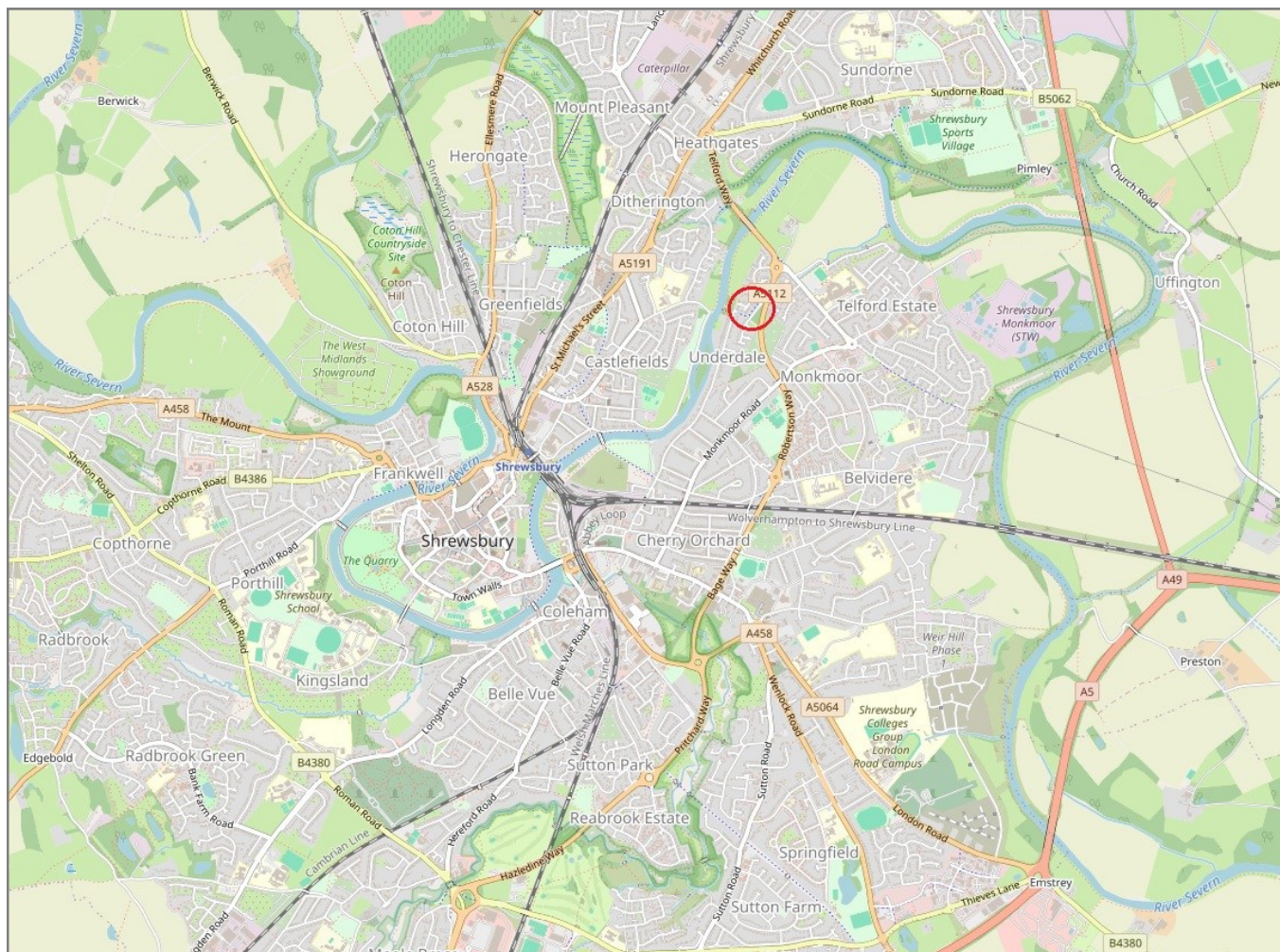

IMPORTANT NOTICE: Cooper Green Pooks for themselves and for the lessors or vendors of this property whose agents they are give notice that: 1 No appliances, services or service installations have been tested and no warranty as to suitability or serviceability is implied. Any prospective purchaser or lessee is advised to obtain verification from their surveyor or solicitor. 2. The particulars are set out as a general outline only for the guidance of the intended purchasers or lessees and do not constitute, nor constitute part of, an offer or contract. 3. All descriptions, reference to condition and necessary permissions for use and occupation and other details are given in good faith and are believed to be correct but any intending purchasers or lessees should not rely on them as statements or representation of fact but satisfy themselves by inspection or otherwise as to the correctness of each of them. 4. No person in the employment of Cooper Green Pooks has any authority to make or give any representation or warranty whatsoever in relation to this property. 5. All rentals and prices are quoted exclusive of Stamp Duty, legal and surveyors fees and any other associated purchasers or lessees costs. 6. Floor plans are indicative only and should not be relied on. 7. The plan showing the boundary of the property is indicative only and has not been checked against the legal title so should not be relied on. 8. All dimensions, floor areas and site areas are only approximate and should not be relied on. Dimensions are generally maximum room dimension.